

SIDE VIEW

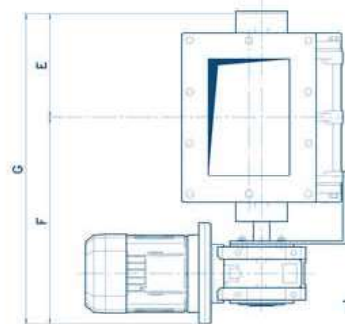

TOP VIEW

| | A | B | C | D | E | F | G | L/Rev. | Rev./1' max | POWER | WEIGHT |
|-----|-----|-----|-----|-----|-----|-----|-----|--------|-------------|---------|--------|
| 200 | 350 | 130 | 480 | 320 | 190 | 380 | 570 | 4,5 | 30 | Kw 0.55 | Kg 80 |
| 250 | 350 | 160 | 510 | 380 | 205 | 395 | 600 | 8 | 30 | Kw 0.55 | Kg 106 |
| 320 | 380 | 195 | 575 | 450 | 221 | 421 | 642 | 16 | 30 | Kw 1,10 | Kg 176 |
| 400 | 400 | 240 | 640 | 570 | 280 | 482 | 762 | 37 | 30 | Kw 1,50 | Kg 282 |
| 480 | 430 | 305 | 735 | 660 | 315 | 517 | 832 | 65 | 30 | Kw 2.20 | Kg 538 |

APPLICATIONS

- METERING
- DISCHARGE
- POWDER
- GRANULE
- GENERAL PNEUMATIC CONVEYING

DESIGN

- FLANGING: SQUARE
- SIZE: 200,250,320,400,480
- HOUSING: CAST IRON CASTING, STAINLESS STEEL AISI 316L CASTING
- ROTOR: WELDED CARBON STEEL OR STAINLESS STEEL AISI 304,AISI 316L
- DRIVE: DIRECT DRIVE AS STANDARD OR CHAIN TRANSMISSION AVAILABLE IN BARE SHAFT VERSION. ALL OUR DRIVES CAN BE CONTROLLED BY INVERTER.
- ROBUST&COMPACT DESIGN WITH MINIMAL ROTOR TOLERANCE

FEATURES

- PRESSURE: 1,5 BAR
- TEMPERATURE: MAX 65 °C
- AIR LEAKAGE: SEE CHART
- INTEGRATED CASTING INNER HOPPER (BETTER FILLING EFFICIENCY)
- 8 VANES OPEN OR CLOSED ENDS ROTOR

OPTIONALS

- DIFFERENT ROTORS FOR DIFFERENT PRODUCTS
- NICKEL COATING
- NICKEL COATING FOOD GRADE
- HARD CHROMIUM PLATING
- VARIOUS POLISHING DEGREES
- FOOD GRADE GASKET
- HIGH TEMPERATURE CONFIGURATION
- FEEDING SHOE
- FEEDING HOPPER COMPLETE WITH AIR INTAKES
- AIR BLOW-IN PURGE
- AIR INTAKES HOLES ON HOUSING
- SPEED DISPLAY
- SPEED CONTROLLER

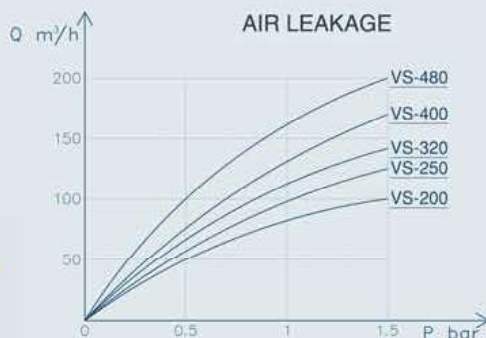

FRONTAL VIEW

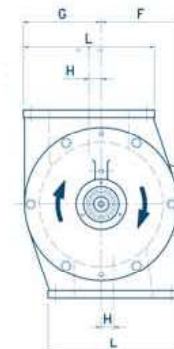
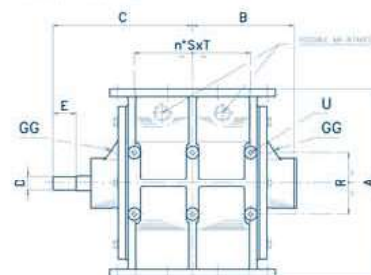

SIDE VIEW

FLANGING VIEW

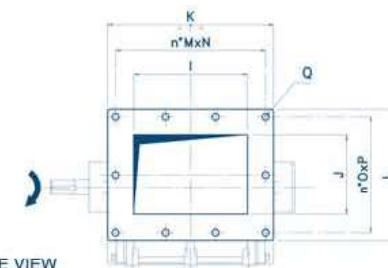

| | A | B | C | D | E | F | G | H | I | J | K | L | M |
|-----|-----|-----|-----|-----|----|-----|-------|----|-----|-----|-----|-----|---|
| 200 | 320 | 190 | 267 | ø30 | 47 | 130 | 132,5 | 20 | 200 | 140 | 285 | 225 | 3 |
| 250 | 380 | 205 | 282 | ø30 | 47 | 160 | 157,5 | 25 | 230 | 160 | 335 | 265 | 3 |
| 320 | 450 | 221 | 304 | ø35 | 53 | 195 | 192,5 | 40 | 260 | 200 | 365 | 305 | 3 |
| 400 | 570 | 280 | 368 | ø40 | 58 | 240 | 237,5 | 55 | 370 | 260 | 475 | 365 | 4 |
| 480 | 660 | 315 | 405 | ø52 | 65 | 305 | 282,5 | 70 | 444 | 300 | 570 | 425 | 4 |

| | N | O | P | Q | R | S | T | U | L/Rev. | WEIGHT | GG |
|-----|-----|---|-----|-----|-----|---|-------|-----|--------|--------|----------|
| 200 | 86 | 2 | 99 | ø12 | 115 | 1 | 210 | M10 | 4,5 | Kg 64 | 1/8" GAS |
| 250 | 101 | 2 | 117 | ø14 | 125 | 2 | 117,5 | M10 | 8 | Kg 90 | 1/8" GAS |
| 320 | 111 | 2 | 136 | ø14 | 175 | 2 | 132,5 | M10 | 16 | Kg 147 | 1/8" GAS |
| 400 | 110 | 2 | 165 | ø14 | 220 | 3 | 125 | M10 | 37 | Kg 260 | 1/4" GAS |
| 480 | 132 | 2 | 191 | ø18 | 220 | 3 | 150 | M10 | 65 | Kg 492 | 1/4" GAS |

BROCHURE



COMPLIANCE



II 1/3DC T135 - II 2/3DC T135